



IT'S ALL ABOUT
YOU

**SMART 2 BHKs AT
HINJAWADI PH - III**

FUTURE
DEVELOPMENT

TOWER - A



YOU57, TOWER A - MahaRERA Registration: P52100021770

maharera.mahaonline.gov.in

Artistic Impression

A LIFE THAT REVOLVES AROUND YOU

Your home is where you raise your family, grow with them and create memories that lasts a lifetime. It's where you dream, where you create your unique sense of identity, a place where you can be truly you.

Understanding these primal associations that a home provides, we have created YOU57 at Hinjawadi, Phase 3 – homes that fulfill the expectations of nobody else but you.

PROJECT HIGHLIGHTS:



4 Towers Spread
Across 2.4 Acres



Futuristic Homes With
Automated Parking



Parallel Towers ensure
Complete Privacy



Experience Tranquility
with Monochrome Design



Vaastu Compliant
Homes



Modern Security
Features Through App



Vibrant Community
Living Experience



Environment Friendly
Practices



Wind Flow
Architecture



Sun-Path
Architecture



Multipurpose Additional
Space in Each Flat



Multi-tier Security at
your finger Tips



LIFESTYLE DESIGNED FOR YOU

Not just our homes, the lifestyle amenities at YOU57 are designed keeping you in mind. Lead a peaceful and healthy life in a home surrounded by acres of greenery along with all the required and desired amenities.

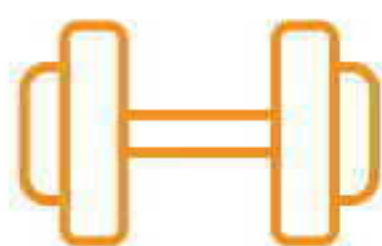

State-of-the-art gym



Jogging / walking track

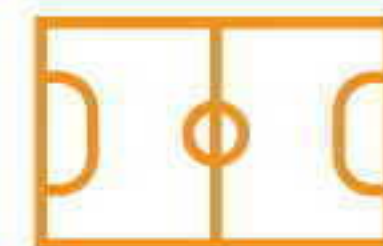

Futsal ground



Indoor games

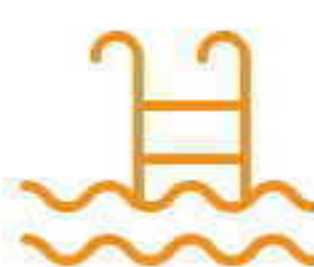

Swimming pool

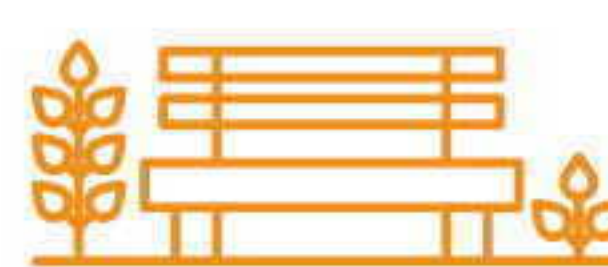

Senior citizen park



Badminton with
BB court (half)



Party lawn with cabana



Multi-utility clubhouse

CHOOSE YOUR OWN CLUBHOUSE AMENITY!



LOCATION CHOSEN FOR YOU

Located in the largest Western Suburb of Pune — Hinjawadi Phase 3, YOU57 keeps you in proximity to IT hubs making it the perfect location for the professionals who work here. You shall be left with a lot more time to spare at the end of a long day. The strategic location is also easily accessible from the Mumbai-Pune Expressway, near to the upcoming metro and proposed Ring Road.

LOCATION

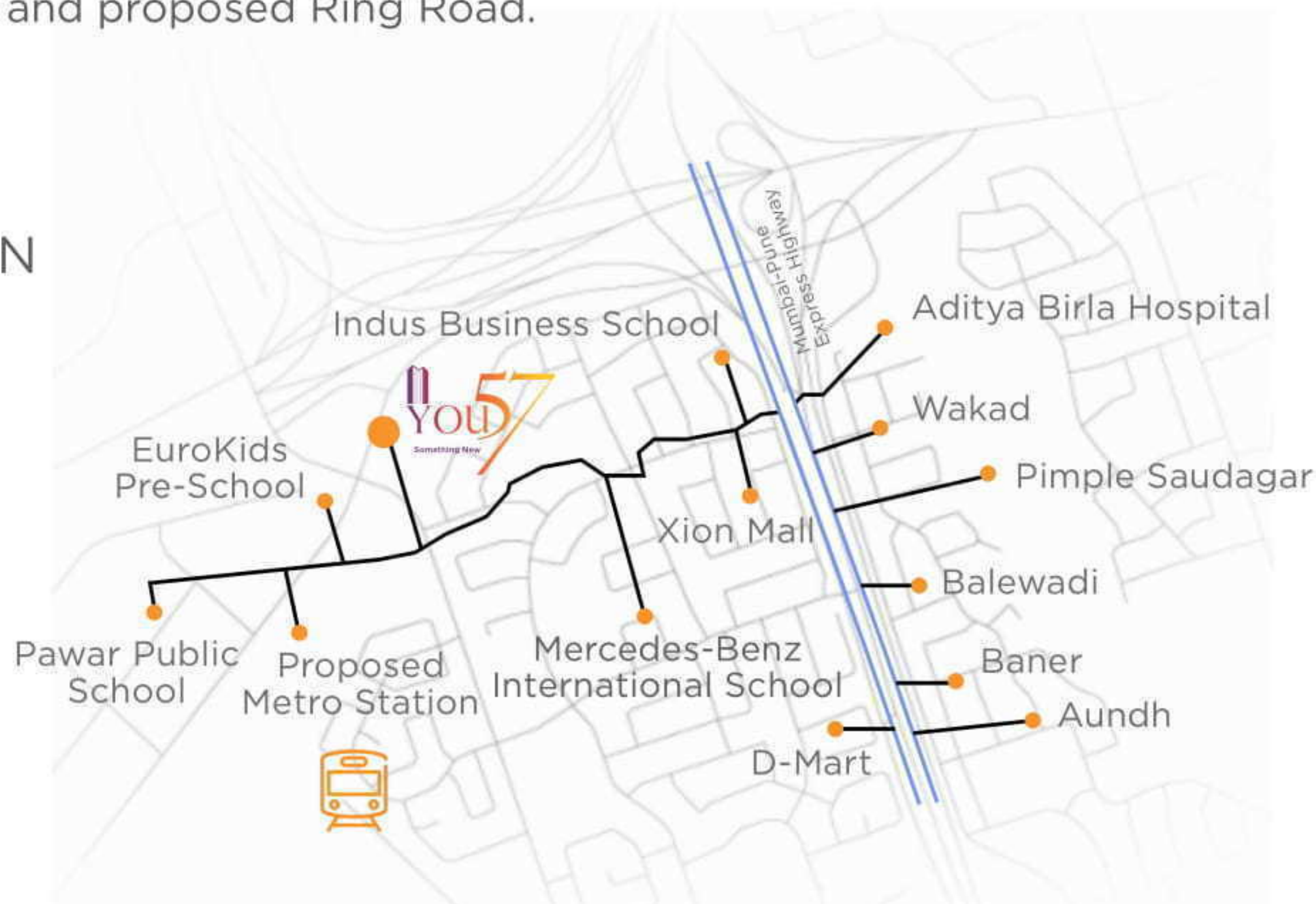

YOU57, TOWER A - MahaRERA Registration: P52100021770

maharera.mahaonline.gov.in



Generations of reliability centered around YOU

SRS Group has a vast portfolio spanning over 40 years. With developments in the city's key locations such as Camp, Boat Club Road, Kalyani Nagar and NIBM Road, we have always strived to deliver the most reliable spaces for you. With over 15 million square feet of timely delivery, immaculate craftsmanship and endless quality, we combine creativity and experience to develop spaces that are tailor-made for You!



📍 Plot no R-3/3/A, Phase III, Rajiv Gandhi Infotech Park, Hinjawadi, Pune 411057.

🌐 www.srsgroup-you57.com ✉ prrem.k@srs-group.in

📞 +91 7507386336 📞 +91 7066326336 📞 +91 7066306336













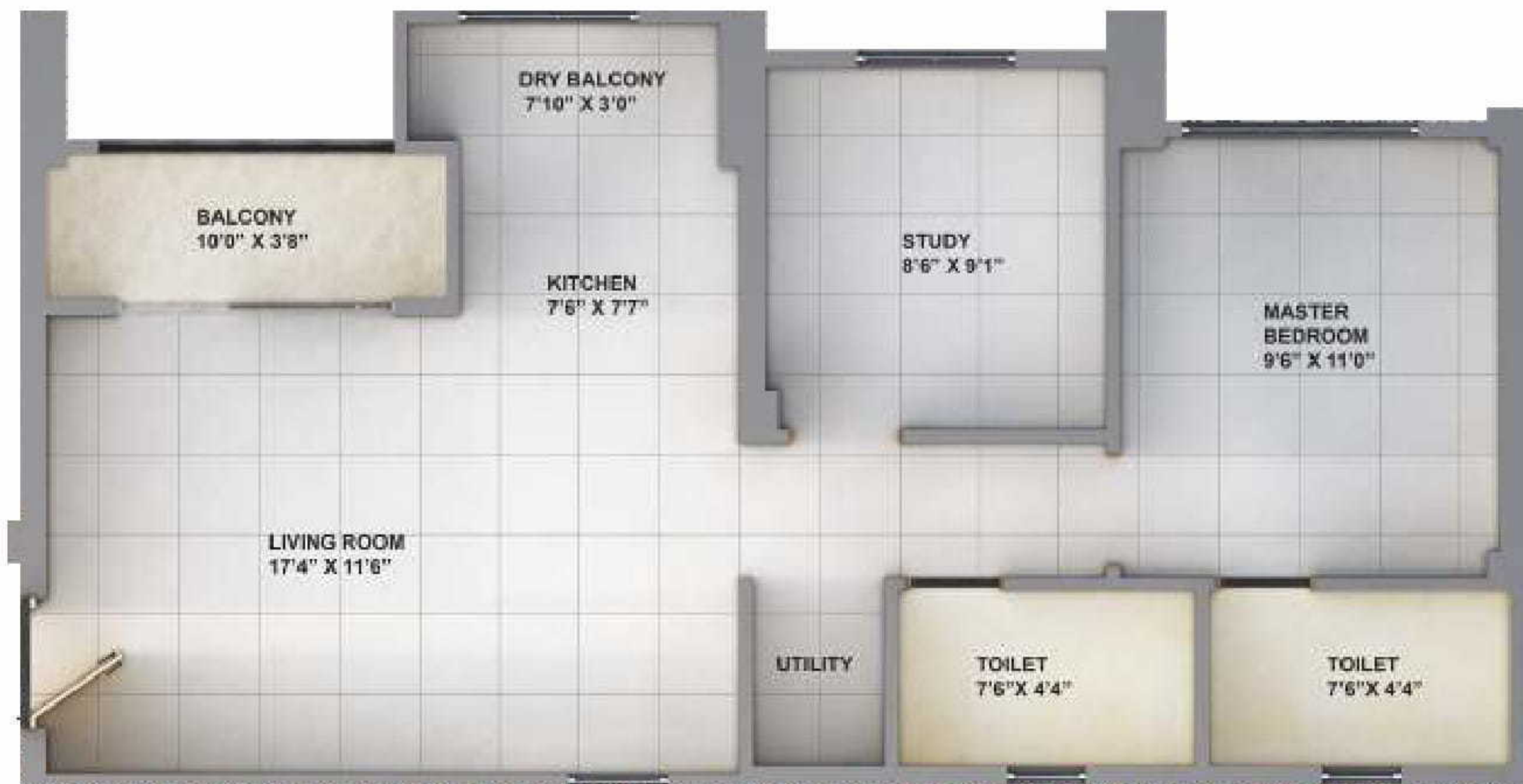

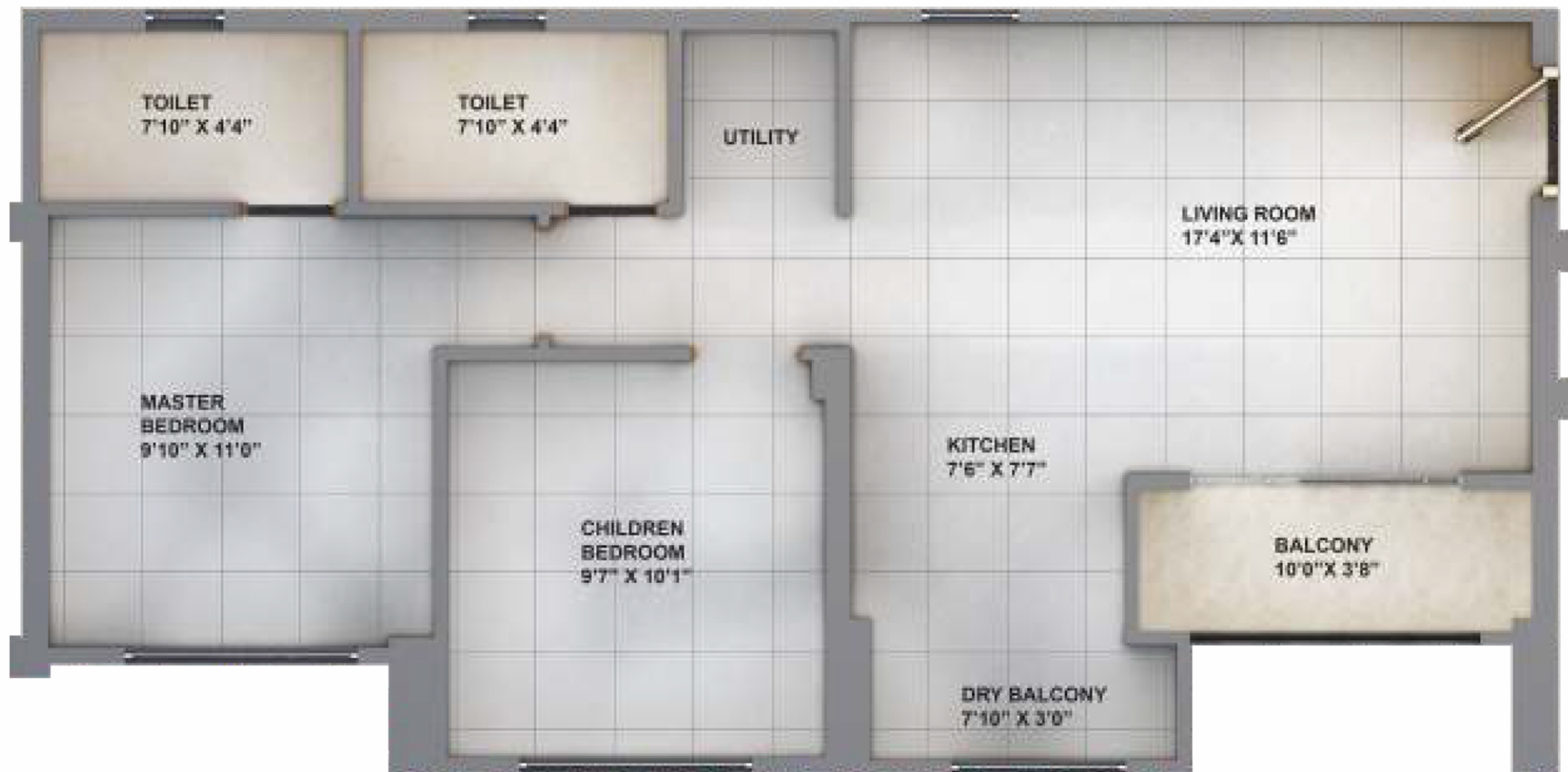

 No 1102, Park Infinia, Phursungi,
Pune – 412308

 +91 77570 06475

 bigtownrealty1@gmail.com



RERA NO. A521000 20542

<https://maharera.mahaonline.gov.in>